

ILLUMINATED ALTERNATE ACTION PUSHBUTTONS

LP5
ILLUMINATED
PUSHBUTTONS

ALTERNATE ACTION, LED ILLUMINATED & SEALED

Front Mount



Raised Dome



The LP5 offers the same rugged, sealed construction as the proven P5 series with the added benefit of reliable LED illumination. It is a precision snap-action switch designed for use in off-highway, material handling, industrial controls, marine, medical and other demanding Commercial applications. Choose from the standard mounting styles and electrical ratings, or contact us for custom configurations.

Now you can design panels with both alternate and momentary action switches and have uniform panel appearance. The OTTO LP5 series features alternate action in the same pushbutton and housing configurations as the OTTO momentary LP3 series.

Push and the LP5 series switch turns "on." Push again and the LP5 switch turns "off." Positive tactile feedback is featured so the operator is clearly aware the switch mode has been actuated. The button returns to the original position after each actuation.

Features:

- **Watertight to IP68S; moistureproof & dusttight to IP64**
- **LED lighted with the ability to accommodate 2, 6, 12 & 24VDC power & includes reverse voltage protection**
- **Tall & dome style buttons in translucent white, red, amber, green and blue permitting sublimated & pad printed legends**
- **Less than 25mΩ contact resistance**
- **Quick disconnect terminals**
- **15/32" & 5/8" thread, press fit & dome case options**
- **RoHS/WEEE/Reach compliant**

Standard Characteristics/Ratings:		
ELECTRICAL RATINGS:		
Load	Sea Level @ 28VDC or 115VAC	
Resistive	5A	
Inductive	3A	
Lamp	1A	
Motor	3A	
DWV	1000Vrms through switch contacts only	
Logic Level	10-100mA @ 3-28V, max DC	
Electrical Life:	Standard 25,000 cycles, Logic Level 200,000 cycles	
LIGHTING:		
Light Source Voltage (DC)	Typ. Forward Voltage (DC)	Voltage Max (DC)
2	1.9 to 3.3 (dep. on color)	2.5 to 4 (dep. on color)
6	6	8
12	12	14.5
24	24	28.6
Mechanical Life:	200,000 cycles	
Seal:	IP64 or IP68S	
Operating Temp Range:	-55°C to +85°C	
Operating Force:	3.0 lbs. +1.0/-0.5 lb.	
Total Travel:	0.180 inches max	
Overtravel:	0.012 inches min	
MATERIALS:		
Case:	Anodized aluminum alloy	
Button:	Thermoplastic	
Mounting Hardware:	Hex nut, lockwasher, and panel gasket (watertight only)	

LP5 PART NUMBER CODE

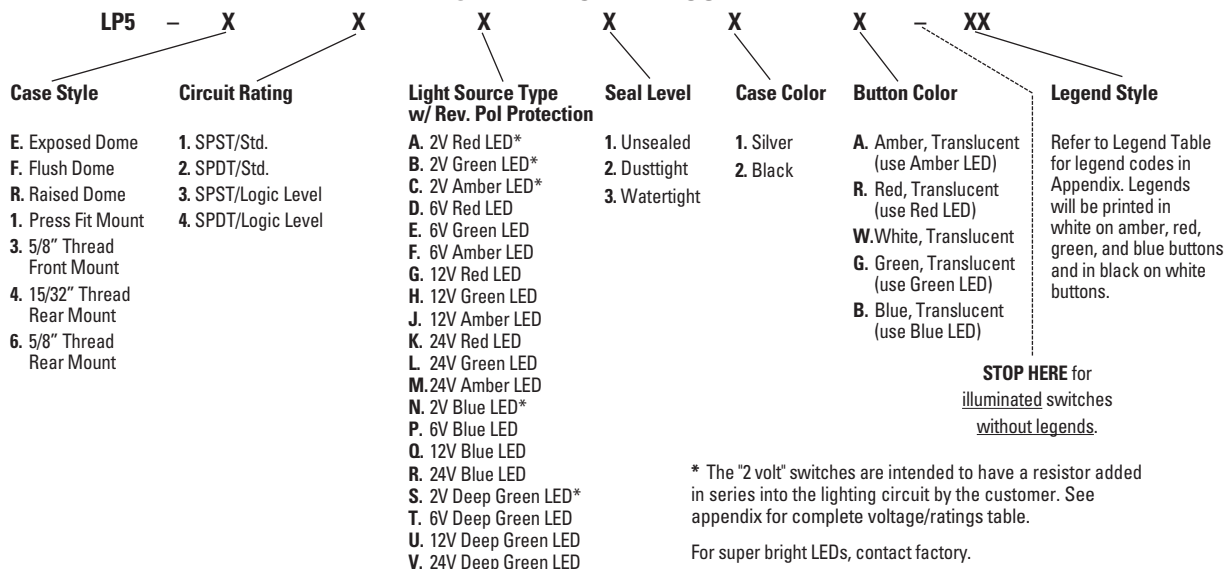

PUSHBUTTONS

ALTERNATE ACTION, LED ILLUMINATED & SEALED

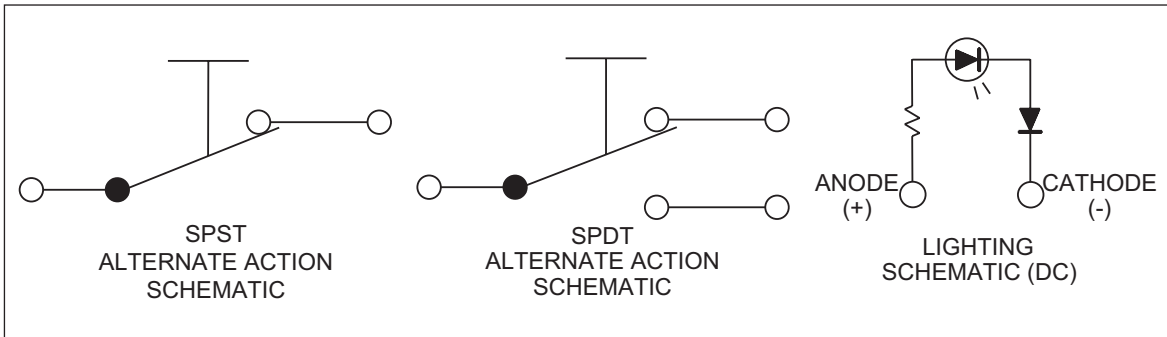

LP5-E
Alternate Action, Exposed Dome Button

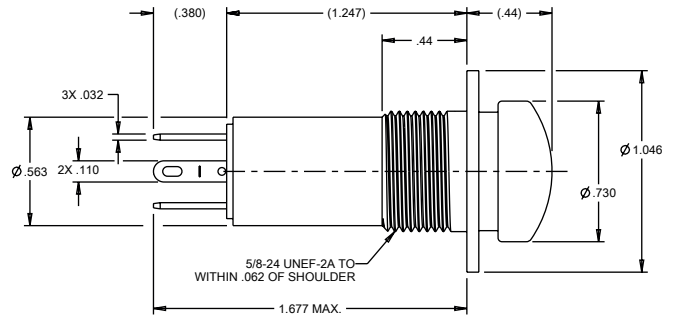
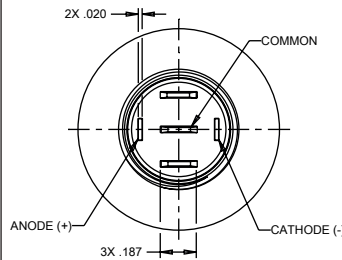
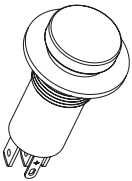

LP5-F
Alternate Action, Flush Dome Button

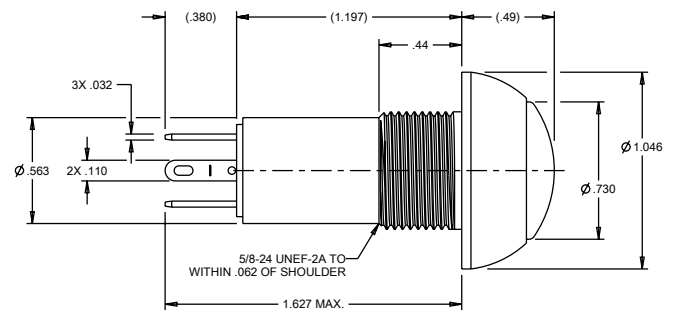
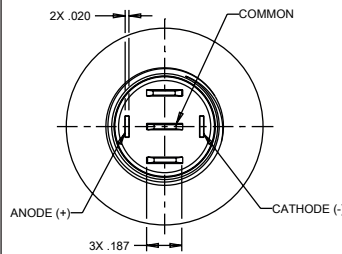
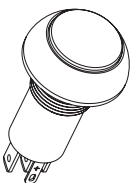

LP5-R
Alternate Action, Raised Dome Button

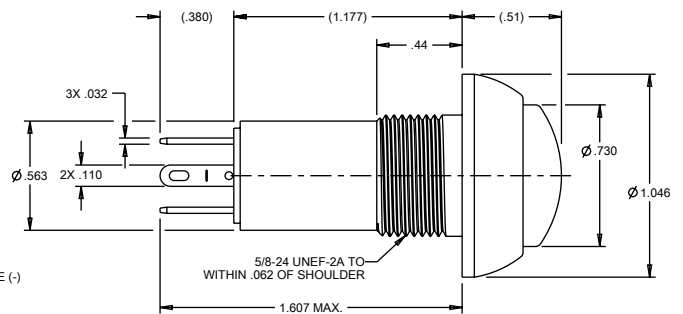
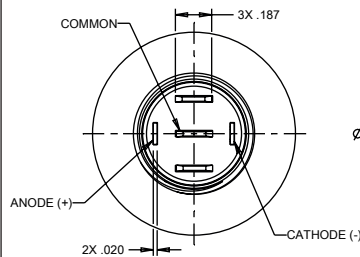
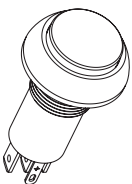

ILLUMINATED ALTERNATE ACTION PUSHBUTTONS

LP5
ILLUMINATED
PUSHBUTTONS

ALTERNATE ACTION, LED ILLUMINATED & SEALED

LP5-1
Alternate Action, Press Fit Mount

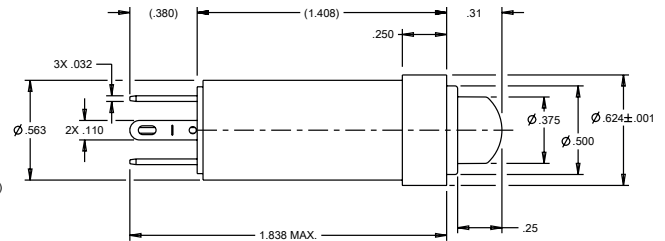
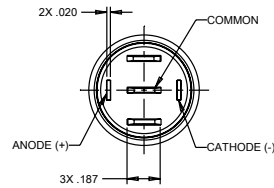
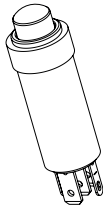

LP5-3
Alternate Action, 5/8" Threaded Front Mount

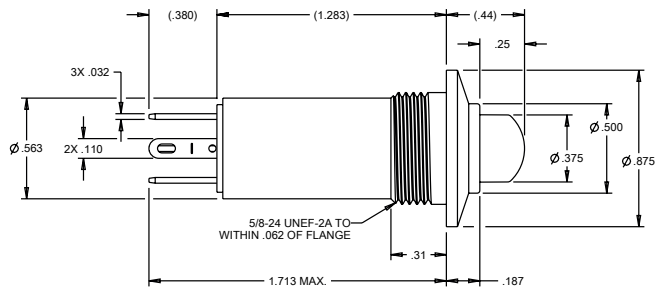
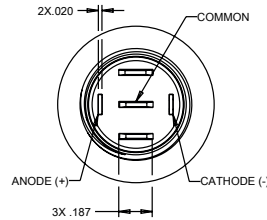
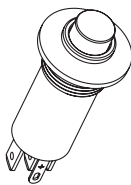

LP5-4
Alternate Action, 15/32" Threaded Rear Mount

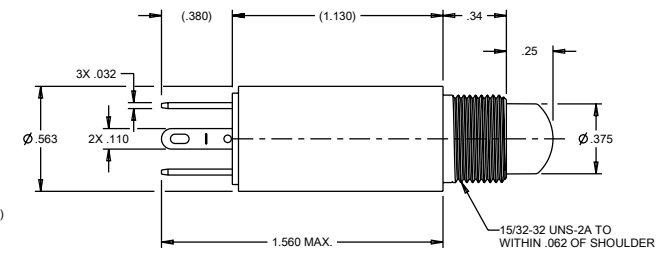
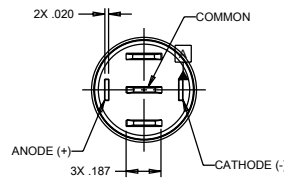

LP5-6
Alternate Action, 5/8" Threaded Rear Mount

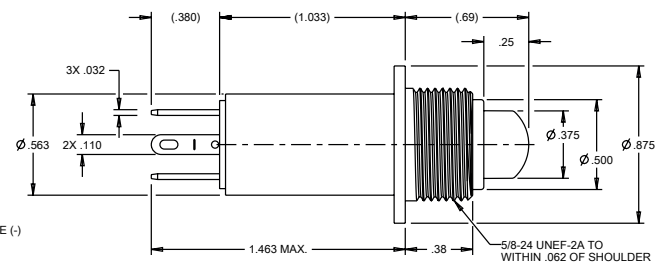
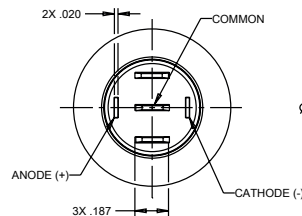
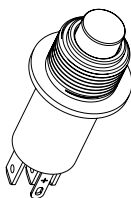

NOTE:
For indicator light only,
see LPL indicator light pages 125-127.

PUSHBUTTONS